

## 漆包线激光测径仪

Enamel wire laser diameter gauge



LGD-FD显示器  
LGD-FD Displayer

### LGD-FD 显示器特点

- ◆ 五位数码管显示
- ◆ 分辨率: 0.0001 mm
- ◆ 继电器 偏差报警输出
- ◆ RS485通讯接口
- ◆ 外型尺寸: 长166 x 宽135 x 高60
- ◆ LGD-02测量头, LGD-05测量头配套使用
- ◆ 配备高品质微型打印机
- ◆ 具备多种打印模式供用户选用
- ◆ 可打印测量值、日期、时间、设备号、线号
- ◆ 适用于漆包线、光纤、不锈钢丝、等超细线的外径非接触无损在线测量

### LGD-FD Displayer Characteristics

- ◆ 5 digit LED displayer
- ◆ Resolution: 0.0001mm
- ◆ Tolerance alarm output
- ◆ RS 485 communication port
- ◆ Dimension: 166x135x60 (Length Width height)
- ◆ LGD-02, LGD-05 kit use
- ◆ Outfit high class mini-printer
- ◆ It has many print model which customer can select
- ◆ It can print object parts value, date, time, equipment No., wire Number
- ◆ Suitable for enamel-insulated wire, Optical fiber, minuteness wire.



LGD-02激光测径仪  
LGD-02 Laser diameter gauge

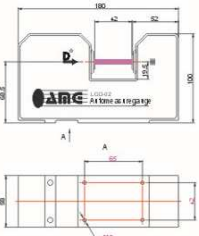

### 技术参数:

测量范围: 0.02~2.0000mm  
测量精度: 0.0005mm  
分辨率: 0.0001mm  
扫描速率: 1200次/秒

### Technique parameters:

Measuring range: 0.02~2.0000mm  
Measuring Accuracy: 0.0005mm  
Resolution: 0.0001mm  
Scanning speed: 1200 scans/sec



LGD-05激光测径仪  
LGD-05 Laser diameter gauge

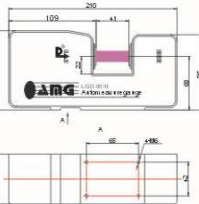

### 技术参数:

测量范围: 0.05~5.0000mm  
测量精度: 0.0005mm  
分辨率: 0.0001mm  
扫描速率: 1200次/秒

### Technique parameters:

Measuring range: 0.05~5.0000mm  
Measuring Accuracy: 0.0005mm  
Resolution: 0.0001mm  
Scanning speed: 1200 scans/sec



### 进口直线导轨

- ◆ 高精度定位
- ◆ 高负载、高刚性、不变形
- ◆ 运动平顺、易于安装

### Outfit linearity orbit

- ◆ High accuracy positioning
- ◆ High loading, high rigidity, don't distortion
- ◆ Smooth movement, easy to mounting

## LMP-02手持式激光测径仪

LMP-02 Portable laser diameter gauge



### LMP-02手持式激光测径仪

LMP-02手持式激光测径仪采用激光扫描技术, 主要适用于高档电子线、漆包线、微拉丝等超细线外径的便携式巡回检测; 产品采用模块化设计, 体积小、重量轻, 使用、维护方便; 配备超强锂电池, 充电时间短, 且充电一次连续使用时间10小时以上。采用大容量FLASH存储器, 可在测量过程中进行实时数据记录保存。

LMP-02 portable diameter gauge adopt laser scanning technique. Product is suitable for high class electronic wire, enamel-insulated wire, filaments itinerate measuring; product adopt SMD module design, small cubage, weight lightly, easy to use and maintenance. Outfit lithium battery, shortly battery charge time, it will work around 10 hours after full charge. Gauge adopts big size Flash Memory. When measuring process, data will be saved into memory.

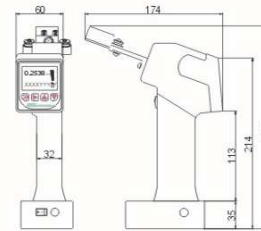

### 技术参数:

测量范围: 0.02~2.0000mm  
测量精度: 0.0005mm  
分辨率: 0.0001mm  
扫描速率: 1200次/秒  
RS485通讯接口  
打印输出接口  
重量: 0.8 kg

### Technique parameters:

Measuring range: 0.02~2.0000mm  
Measuring Accuracy: 0.0005mm  
Resolution: 0.0001mm  
Scanning speed: 1200 scans/sec  
RS 485 communication port  
Printing output port  
Weight: 0.8 kg

## LGD-02XY微细线激光测径仪

LGD-02XY minuteness wire laser diameter gauge



LGD-02XY激光测径仪  
LGD-02XY Laser diameter gauge

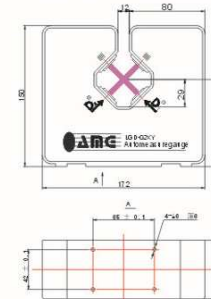

### 技术参数:

测量范围: 0.02~2.0000mm  
测量精度: 0.0005mm  
分辨率: 0.0001mm  
扫描速率: 1200次/秒

### Technique parameters:

Measuring range: 0.02~2.0000mm  
Measuring Accuracy: 0.0005mm  
Resolution: 0.0001mm  
Scanning speed: 1200 scans/sec

### LGD-02XYFD显示器功能特点

- ◆ 五位数码管显示
- ◆ 分辨率: 0.0001 mm
- ◆ 继电器 偏差报警输出
- ◆ RS485通讯接口
- ◆ 外型尺寸: 长189 x 宽185 x 高125
- ◆ LGD-02XY测量头配套使用
- ◆ 配备高品质微型打印机
- ◆ 具备多种打印模式供用户选用
- ◆ 可打印测量值、日期、时间、设备号、线号
- ◆ 适用于漆包线、光纤、不锈钢丝、等超细线的外径非接触无损高精度在线测量

### LGD-02XYFD Characteristic

- ◆ 5 digit LED displayer
- ◆ Resolution: 0.0001mm
- ◆ Tolerance alarm output
- ◆ RS 485 communication port
- ◆ Dimension: 189x185x125 (Length Width height)
- ◆ LGD-02XY kit use
- ◆ Outfit high class mini-printer
- ◆ It has many print model which customer can select
- ◆ It can print objective parts value, date, time, equipmentNo., wire Number
- ◆ Suitable for enamel-insulated wire, Optical fiber, minuteness wire.



LGD-02XYFD显示器  
LGD-02XYFD Displayer